

19/05794/R9FUL  
Scale 1/2500

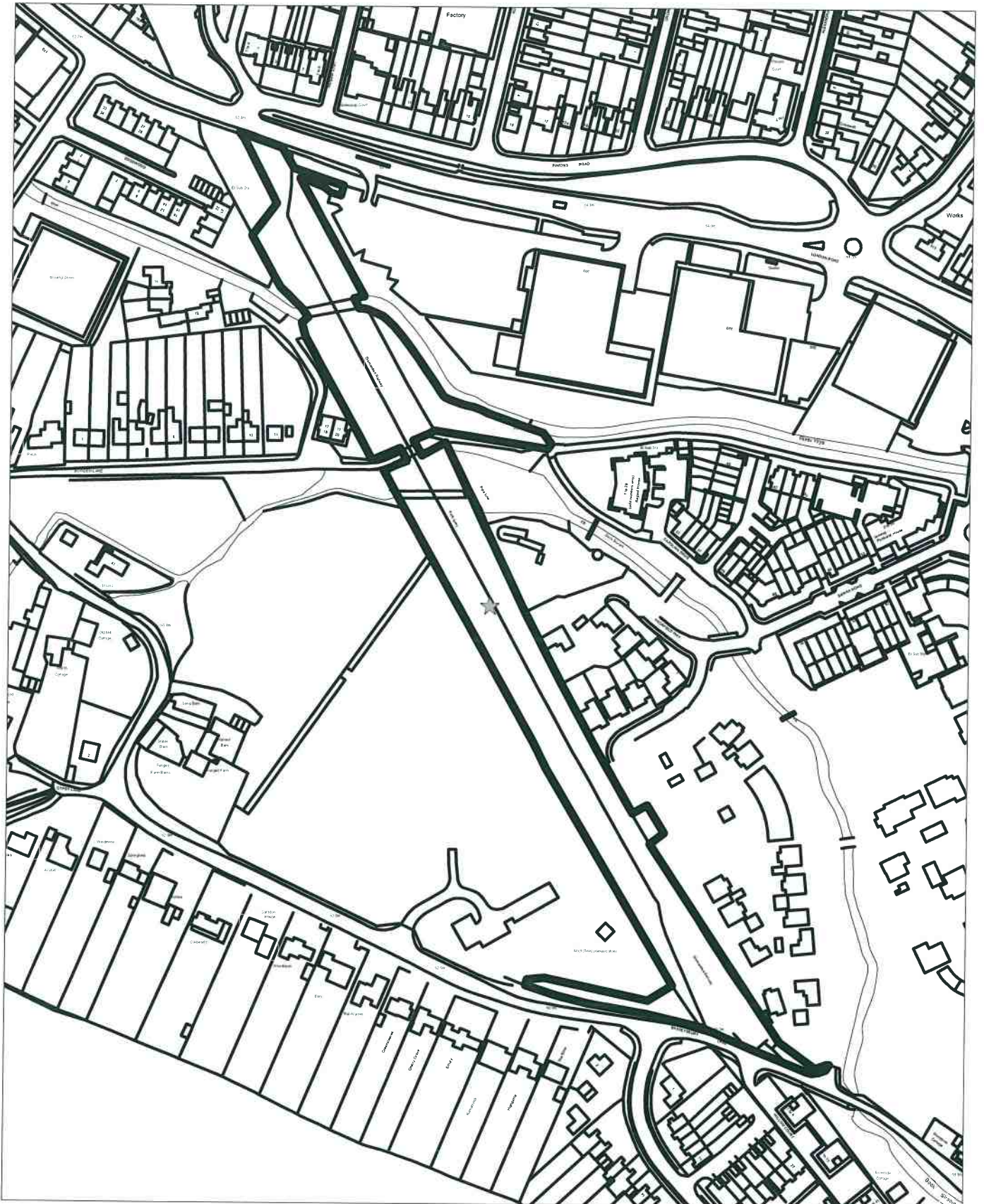

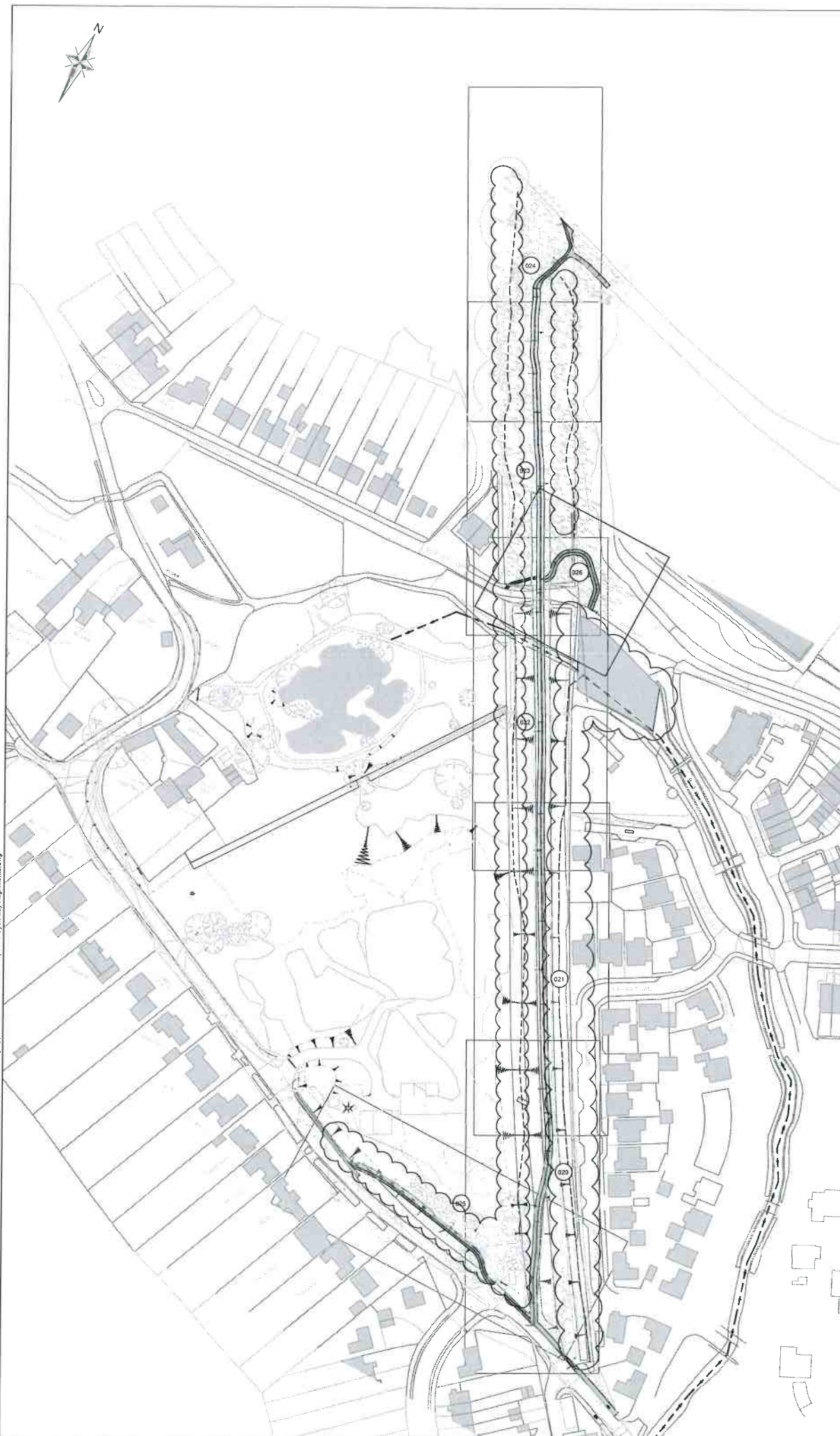



- NOTES**
1. ALL DIMENSIONS SHOWN IN METRES UNLESS NOTED OTHERWISE.
  2. NO DEVIATION FROM THE DETAILS SHOWN ON THIS DRAWING IS PERMITTED WITHOUT PERMISSION FROM THE ENGINEER.
  3. TOPOGRAPHICAL SURVEY UNDERTAKEN BY 1ST HORIZON SURVEYING AND ENGINEERING ON THE 13TH OF JANUARY 2017.
  4. SITE LAYOUT BASED ON SAVILLS DRAWING 078/07320 - REV E RECEIVED 23/11/2017

- KEY**
- PROPOSED ALIGNMENT AND PROFILE
  - - - EXISTING GROUND LEVEL
  - PROPOSED SHARED FOOTWAY/CYCLEWAY TO BE CONSTRUCTED IN A COMPACTED HOGGIN SURFACE
  - PROPOSED SHARED FOOTWAY/CYCLEWAY TO BE CONSTRUCTED IN A SEALED FINISH
  - PROPOSED RAMP CONNECTION
  - PROPOSED RETAINING WALL
  - - - EXISTING DITCH
  - PROPOSED FLOW PATH
  - EXISTING WATERCOURSE

C:\116-155 - Bassetsbury Road - Wycombe\Tech\Acad\Drawings\Detailed Design - Footway/Cycleway drawings\For Planning Approval\16-155-020-027 Proposed Cycleway Alignments.dwg

E	EXISTING & PROPOSED LAND DRAINAGE FEATURES ADDED	OL	MR	MR	15/10/19
U	DRAFT STAMP AND NOTE REMOVED	MR	MR	MR	18/04/19
C	NEW FOOTPATH ADDED TO CONNECT TO EXISTING CAR PARK	MR	MR	MR	18/02/19
B	NEW PROPOSED FOOTPATH ADDED	COL	MR	MR	09/11/18
A	GENERAL AMENDMENTS	COL	MR	MR	23/11/18
	DRAFT FOR REVIEW	COL	MR	MR	17/09/18
Rev	Amendments	On	Chk	App	Date

**ODYSSEY**

14000000 0276 202444  
 14000000 0276 202444  
 14000000 0276 202444  
 14000000 0276 202444

Job No: **BASSETSBURY ROAD, HIGH WYCOMBE**

Drawing Title: **PROPOSED SHARED FOOTWAY/CYCLEWAY ALIGNMENTS OVERVIEW**

Client: **WYCOMBE DISTRICT COUNCIL**

Scale: <b>1:750 @ A1</b>	Date: <b>OCT 18</b>	Designed: <b>CDU</b>
Drawn: <b>CDU</b>	Checked: <b>MR</b>	Approved: <b>MJB</b>
Job No: <b>16-155</b>	Drawing No: <b>16-155-027</b>	Rev: <b>E</b>